

OASIS

Orioles **A**lternative **S**etting **i**n **S**chool

***Oasis**: A place of peace, safety, happiness in the midst of trouble or difficulty

Presented by

Susie Hurt - Director of Special Education

Dustin Robinson - OASIS Coordinator

8/29/23



AVON

COMMUNITY
SCHOOL
CORPORATION

Special Education and LRE

LRE – Least Restrictive Environment

- 50 General Ed classroom (80% or more of the day)
- 51 General Ed + Resource Room
- 52 Separate class (STRIVE & IMPACT)
- **53 Separate day school facility**
- 54 Residential facility



AVON

COMMUNITY
SCHOOL
CORPORATION

The WHY

- **2014-15:** Avon, Brownsburg, and Plainfield created a Separate Day School (attached to Harris Academy)
- **2020-21:** Plainfield started their own Separate Day School (attached to Plainfield MS)
- **July 2020:** Brownsburg gave notice to Avon of desire to dissolve ALPHA partnership allowing each district to house their own program
- **2020-21:** Explored options to locate Avon Separate Day School
- **2022-2023:** Open temporary space down a wing of our preschool center while permanent location was built at the high school
- **July 2023:** OASIS opened in our permanent location built off Avon High School



The WHO

YEAR	ELEM	MS	HS	TOTAL
2014-15	5	4	8	17
2015-16	9	2	7	18
2016-17	5	2	12	19
2017-18	5	4	8	17
2018-19	5	4	7	16
2019-20	9	2	4	15
2020-21	5	4	4	13
2021-22	8	6	6	20
2022-23	7	6	4	17
2023-24	5	4	7	16

This number has varied this year. 6 other students have been in the program but have left for various reasons (move, graduate, residential, etc)

SITE VISITS & Take-Aways

Site Visits

- Plainfield
- Hamilton-Madison-Boone
- Fishers
- RISE
- Franklin Township
- ALPHA
- Sanders

Take Aways

- **Space**
 - classrooms
 - lunchroom/cooking space
 - multi-purpose rooms
 - sensory rooms
 - therapy rooms (OT, PT, SLP, Counselor)
 - multiple flexible spaces
 - offices/conference space
- **Secured doors/separate entrance**
 - Doors on time release
- **Staff**
 - Teachers, counselor/social worker, behavior specialist, paras, coordinator, building admin support



Program Transition for Temporary Location

2022-23

- Open temporary separate day school (grades K-12)
- Hire staff
 - Coordinator (non-administrative position)
 - Behavior Specialist/Counselor/Social Worker
 - Teachers (3) - K-5, 6-8, 9-12
 - Paraprofessionals – 4 full time positions
 - Consider Administrative Position – AHS Special Ed Asst. Principal



AVON

COMMUNITY
SCHOOL
CORPORATION

Program Transition Considerations

2023-24

- Avon Separate Day Program Moves to Avon High School
- Separate entrance at Avon High School
 - Efficient administrative oversight - AHS Sp. Ed Asst. Principal; Director of Special Education
 - Shared resources (nurse, kitchen, secretarial, School Resource Officer, etc.)
 - Fiscally responsible with renovation/expansion work being designed at AHS

OASIS Budget 2022-2024

	Budgeted amount	Actual
Size	12,000 square feet	
Salary + Benefits: 1 coordinator 1 Social Worker 3 Teachers 4 FT IAs *2023-34 added Behavior Specialist (Medicaid \$\$)	\$646,326	\$565,201
Cost to revamp current space – elem classrooms (White Oak)		\$488,112
supplies/materials		\$32,027.60
Cost per pupil		\$33,247.11

How We Keep Kids and Staff Safe

- ALL staff trained in ProAct
- Relationship building with our SROs
- Class lessons from Social Worker
- Weekly individual lessons with Social Worker
- All exterior doors are secured, alarmed and on a 15 second lock/release
- All interior doors remain locked
- Separate entrance from front door of building
- Bus drop off at door
- Fence outdoor space
- All rooms have a secured time out/seclusion room



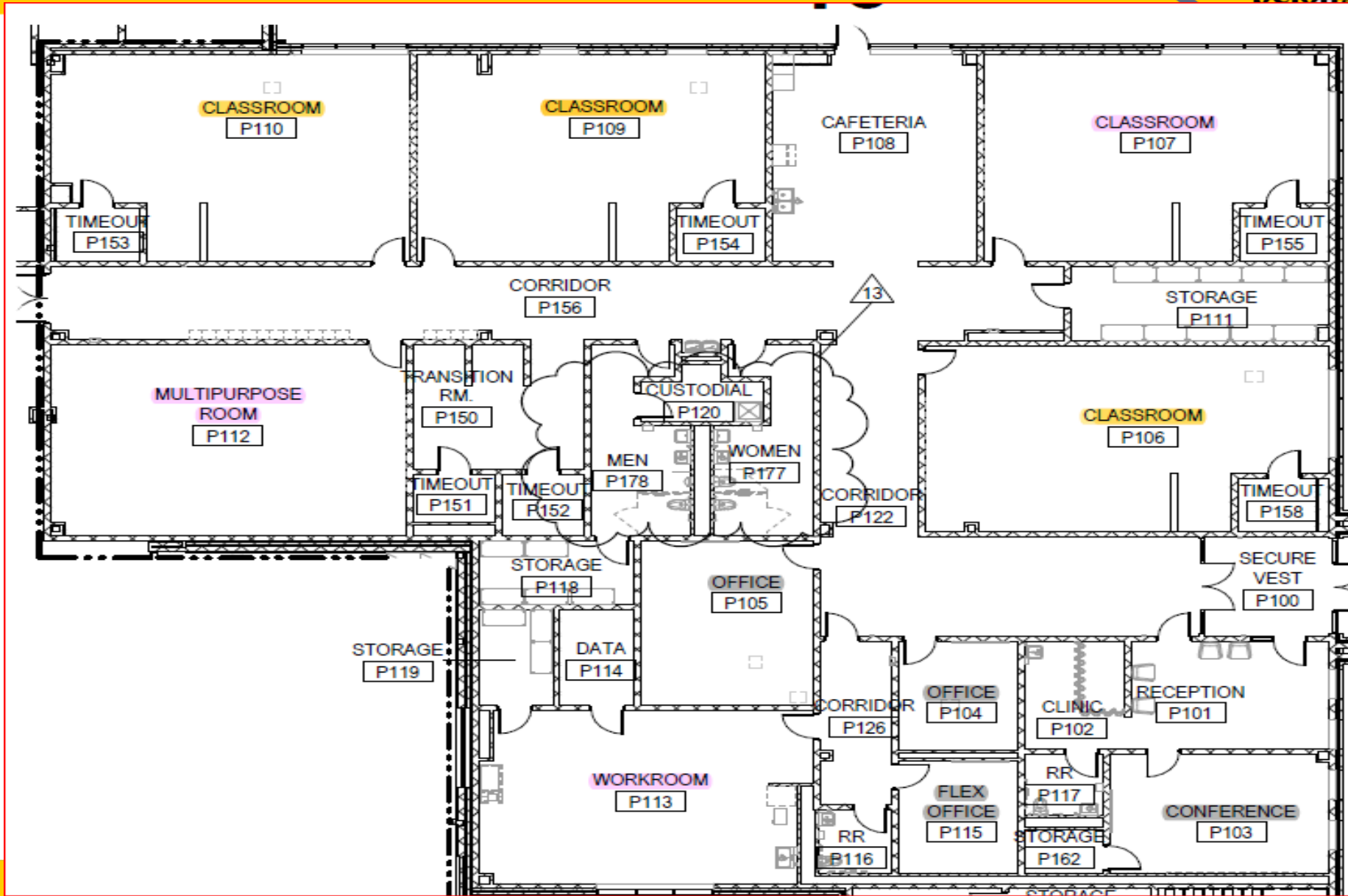

Creating the Program

Putting it all Together



AVON

COMMUNITY
SCHOOL
CORPORATION

First Steps

- Observations of Similar Programs
 - Alpha, Rise, Sanders, New Connections
- Creation of Documents
 - Incident Report Form, Debriefing forms, electronic input of forms, Data disaggregation methods
- Behavior Data Collection
 - Each student's daily sheet and data profile
- Systems
 - PLCs
 - Deep dive, Restraint/Seclusion Debrief, Mental Health, data dives
 - PBIS, Reinforcers, Following a behavior, data tracking, Behavior Plan changes, etc.



PBIS

	Own my actions and words	Attentive to task	Safe In My Space
Classroom	<ul style="list-style-type: none"> Respect property and people Be honest Ask for help Use kind words 	<ul style="list-style-type: none"> Complete work or assigned tasks Engage in the activity Conversations are on topic 	<ul style="list-style-type: none"> Get permission to leave the space Cabinets are off-limits without permission Keep hands, feet, and body to self
Hallways	<ul style="list-style-type: none"> Voice level 0 or 1 Keep hands, feet, and body to self Respect the learning environment 	<ul style="list-style-type: none"> Follow the teacher's instructions Stay behind the person in front of you 	<ul style="list-style-type: none"> Respect the personal space of others Hands, feet, and body to self Walking feet
Bathroom	<ul style="list-style-type: none"> Leave the restroom clean <ul style="list-style-type: none"> Flush the toilet Throw away paper towels Level 0 voice Floors stay dry 	<ul style="list-style-type: none"> Get in and get out I only need myself, not other items (e.g., cell phone, pens, pencils, etc.) 	<ul style="list-style-type: none"> No playing in the bathroom
OASIS Support Center	<ul style="list-style-type: none"> Level 2 voice at most Use appropriate words and language Restore the space and environment 	<ul style="list-style-type: none"> Follow instructions of the teacher Clean any mess made Complete the original task 	<ul style="list-style-type: none"> I am not hurting myself or others Safe hands and feet My body is calm
The Island	<ul style="list-style-type: none"> Use level 2 or 2.5 voice Use equipment as intended Leave the space clean 	<ul style="list-style-type: none"> Keep the space clean When the timer stops, I stop Share the space Stay in the intended area 	<ul style="list-style-type: none"> Feet on the ground Walking feet Use the space for intended purposes Safe hands and feet Use equipment appropriately

Behavior & Academic Reinforcers

- Behavior Reinforcer (sand dollar)
 - Tied to every behavior expectation (specific and frequent)
 - Short term, mid-range, long range behavior reinforcer
 - ALL ADULTS participate
 - Adult behavior reinforcement
- Academic Reinforcer (tickets)
 - Short term = ticket (\$0.25)
 - Mid-range = earned time
 - Long-range = McDonalds, Five Below, Arby's, etc.
- Partners with local church who provides all snacks and funding for reinforcers

Store Menu

Middle School/High School Store			
Item	Price	Item	Price
 <p>one piece of candy (Sour Patch/ Swedish Fish, chocolate, Airhead, Jolly Rancher)</p>	\$5		
Item	Price	Item	Price
 <p>one sticker</p>	\$1		\$10
 <p>one bag of chips</p>	\$10	 <p>one squishie</p>	\$15

Item	Price	Item	Price
<p>Tea Pass (HOME/ Lunch)</p> 	\$15	<p>Pop Pass (HOME/ Lunch)</p> 	\$10
 <p>SLIME</p>	<p>Small: \$20</p> <p>Medium: \$30</p> <p>XL: \$40</p>	 <p>Limit: 5 per day</p>	\$1
 <p>one package</p>	\$15	 <p>one candy bar</p>	\$15

Schedule

- Master Schedule
 - Academic Blocks
 - Elementary has shorter blocks with more breaks
 - Middle & High school has 50 min. blocks
 - Lunches
 - Moved to all lunches at the same time this year
 - Dedicated cafeteria space rotation
 - Behavior Support Staff Schedule
 - Beh
 - Everyone has someplace to be throughout the day
 - Breaks/Fun Friday



Master Schedule

Time	Elementary	Middle	HS	Social Worker	Behavior Specialist	Floating IA
8:00	Breakfast/	Breakfast/	Breakfast/	Breakfast/	Breakfast/	Breakfast/
8:05	Check-In	Check-In	Check-In	Check-In	Check-In	Check In
8:10						
8:15						
8:20	Reading	8:00-8:30	8:00-8:30	HH	Elementary	HS English
8:25	8:20-8:50			(8:20-8:40)	Support	8:20-8:50
8:30					(8:20-8:50)	
8:35		Specials	English	JD/Jav.J.	Check-In	
8:40		8:30-9:15	8:30-9:20	(8:40-9:10)	Elementary	Floating Breaks
8:45	Break				Support	
8:50					(9:00-9:25)	HS English
8:55						9:05-9:20
9:00	Math	Break	Break	AC/KK		Floating Breaks
9:05	9:00-9:25			(9:10-9:30)		
9:10						
9:15						
9:20	Break					
9:25						
9:30	Specials/			ES/EB		
9:35	Science/ Soc.	Science	Math	(9:30-9:50)	HS Support	Elementary
9:40	9:30	9:25-10:15	9:30-10:20	JD/DE	(9:30-10:20)	9:30-10:15
9:45	10:15			(9:50-10:10)		
9:50						
9:55						
10:00						
10:05						
10:10				Prep/Data Entry		Breaks & Recess
10:15	Recess	Break	Break	(10:10-10:40)		
10:20	10:15-10:40				MS	Lunch
10:25		English	Specials		(10:20-11:00)	10:30-11:00
10:30		10:25-11:10	10:30-11:15	SEL		
10:35				Elementary		
10:40	SEL (Kimble)			10:40-11:15		
10:45	10:40-11:15				Data Entry	MS Support
10:50					11:00-11:30	11:00-11:25
10:55						
11:00						
11:05		Recess	CNN 10	Prep/Data Entry		
11:10	Lunch Prep	11:10-11:30				
11:15						
11:20						
11:25						
11:30	Lunch	Lunch	Lunch	Lunch	Lunch	Lunch
11:35	11:30-12:00	11:30-12:00	11:30-12:00	Supervision	Supervision	Supervision
11:40				11:30-12:00	11:30-12:00	11:25-12:05
11:45						
11:50						
11:55						
12:00	Head Aloud	Transition	Transition	Transition	Transition	Transition
12:05	12:00-12:15	Midday		BP/JJ (12:05-		Floating
12:10		Check/clean		12:20)	Lunch	Support
12:15					12:05-12:35	12:05-12:35
12:20	Reading	SEL 12:20-	Science	SEL - Middle		Elementary
12:25	12:15-12:45	12:50	12:05-12:55	School		12:30-12:50
12:30				(12:20-12:50)		
12:35					MS Support	Elementary
12:40	Break	Break			12:35-1:20	Math
12:45						12:50-1:20
12:50						
12:55						
1:00	Math	Math	Gym	Lunch		
1:05	12:50-1:20	1:00-1:40	12:55-1:25	(12:50-1:20)		
1:10						
1:15						
1:20	Break					
1:25						
1:30	ELA			SEL	Elementary	MS Support
1:35	1:25			High School	Support	1:20-1:50
1:40				(1:25-1:55)	1:20-1:55	
1:45		Break				
1:50						
1:55						
2:00	Earned Time	Social Studies	Social Studies	KL/EC (1:55-2:15)	School Store	HS Support
2:05	2:00-2:20	1:50-2:20	1:25-2:15		1:55-2:20	1:50-2:20
2:10						
2:15						
2:20	PU/Dismissal		Pack-Up/	Pack-Up/	Pack-Up/	Dismissal
2:25		PU/Dismissal	Dismissal	Dismissal	Dismissal	



Specials

- Three 45-minute sessions Tuesday-Thursday
 - Middle, Elementary, High School
- Art & Music
 - Outside Contractors (8:30 – 11:30)
 - Quarterly Meetings
- Library & STEM
 - Avon Staff
 - Library houses books from each level at OASIS on rolling carts
 - Both specials are now offered to middle and high school



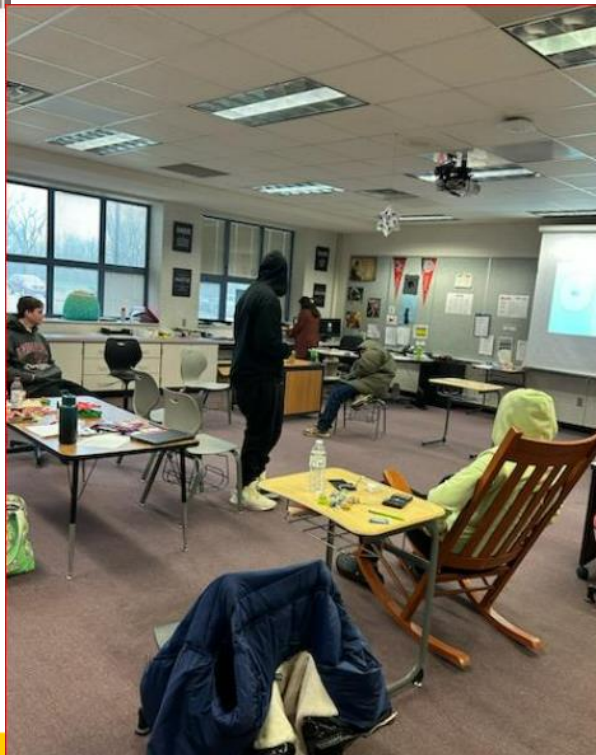
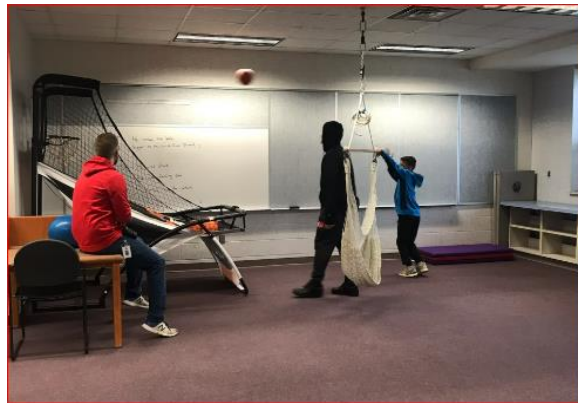
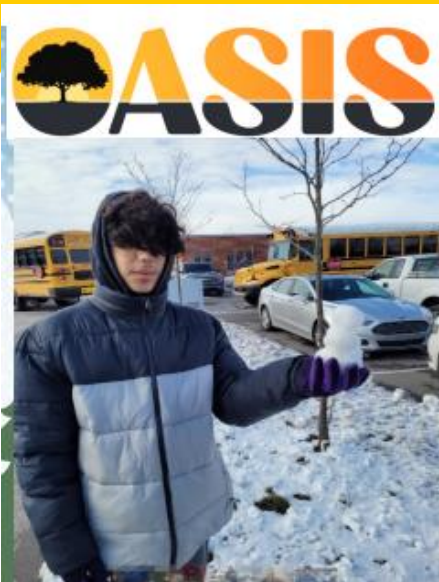

AVON

COMMUNITY
SCHOOL
CORPORATION

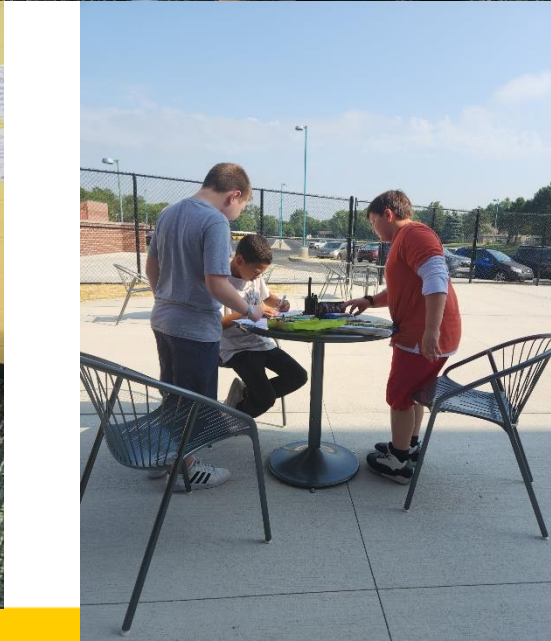

QUESTIONS?



AVON

COMMUNITY
SCHOOL
CORPORATION